



WALL SOUNDPROOFING

FRAMELESS CLADDING USING ZIPS SANDWICH-PANELS

ZIPS-SLIM

FOR INNER APARTMENT WALLS MADE OF AAC/GC!

MAX LOAD WITHOUT INSERTS 35 kg/r.m.

CONSTRUCTION THICKNESS 37,5 mm

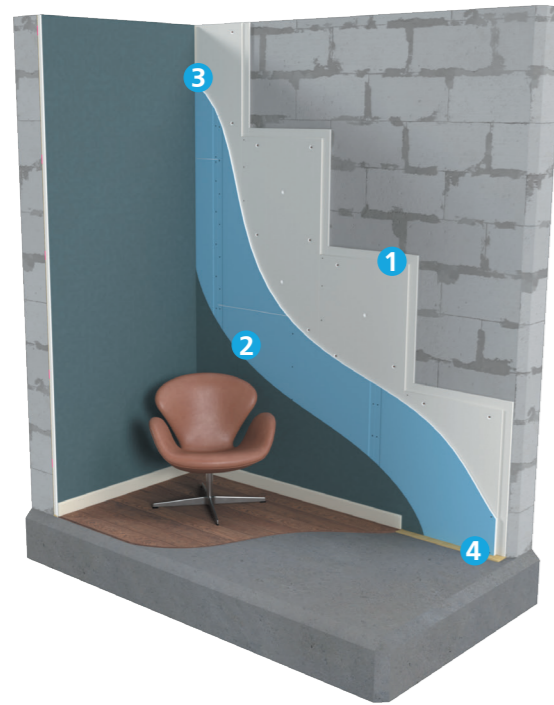

$\Delta R_w \approx 11$ dB additional airborne noise insulation

$R_w \approx 55$ dB

airborne noise insulation index for the entire construction when mounted on a partition made of 200 mm (8 in) thick D600 gas silicate blocks

When applied?

- When the wall on which installation is to be performed is made of 200 mm thick gas silicate blocks.
- Saves from noises of average volume - conversations, TV, barking dogs, crying children.

ZIPS-SLIM

ultra-thin frameless sound insulation for inner autoclaved aerated concrete apartment walls

- Fireproof material
- Certified
- Has a European certificate
- Passed acoustic tests



1 ZIPS-SLIM sandwich-panel 1200x600x25 mm with a mounting kit average consumption per 1 m² = 1.5 pcs.

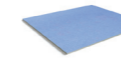

2 AKU-Line plasterboard sheet 2000 x 1200 x 12,5 mm average consumption per 1 m² = 0.42 pcs.



3 Vibroseal silicone neutral sealant 290 ml cartridge average consumption per 1 m² = 0.4 pcs.



4 Vibrostack-M 100 Tape vibration damping spacer roll 30m width 100mm thickness 4 mm (3 m²) average consumption per 1 m² = 0.73 pcs.



Approximate cost of the construction, based on m²

€/m²



INSTALLATION MANUAL

ZIPS-SLIM panels are attached to the wall only through the existing vibration units using plastic dowels.

The ends of the sandwich-panels must adjoin the side walls and the ceiling through two layers of Vibrostak-M 100 Tape vibration damping spacer. The tape is glued and fixed with Vibroseal.

The head of the screw should be screwed into the vibration unit no deeper than 1-2 mm from the level of the front side of the panel.

If the panel is cut, then all available attachment points are used for installation. Cuttings less than 250 mm are not used in the installation.

Upon completion of installation, the joints between the sandwich-panels are treated with Vibroseal. The finishing layer of AKU-Line plasterboard sheets 12.5 mm thick is fixed to the resulting surface. Sheets must adjoin to the adjacent surfaces through 2 layers of Vibrostak-M 100 Tape vibration insulating spacer as well.

Excessively protruding Vibrostak-M 100 Tape is cut flush with the finishing layer of AKU-Line plasterboard sheets. Seams are filled with Vibroseal vibroacoustic silicone sealant.